

Stoffe  
Schichten

Meine persönliche Karte vom Erdinneren

1/13



# Meine persönliche Karte vom Petrium

Keblerstrasse

Wegener

1.0.2004 bis 1.0.2005

Hauzeingang  
Norden

1.a Klasse  
im  
3. Stock

1.b Klasse  
3. Stock

1.c Klasse  
3. Stock

Eingangshalle

Sanitär

GAZ  
Tisch

TÜR

Festsaal  
Erdgeschoss

Süden

Kletterwand

Fussballplatz

Weitsprung

Sportplatz

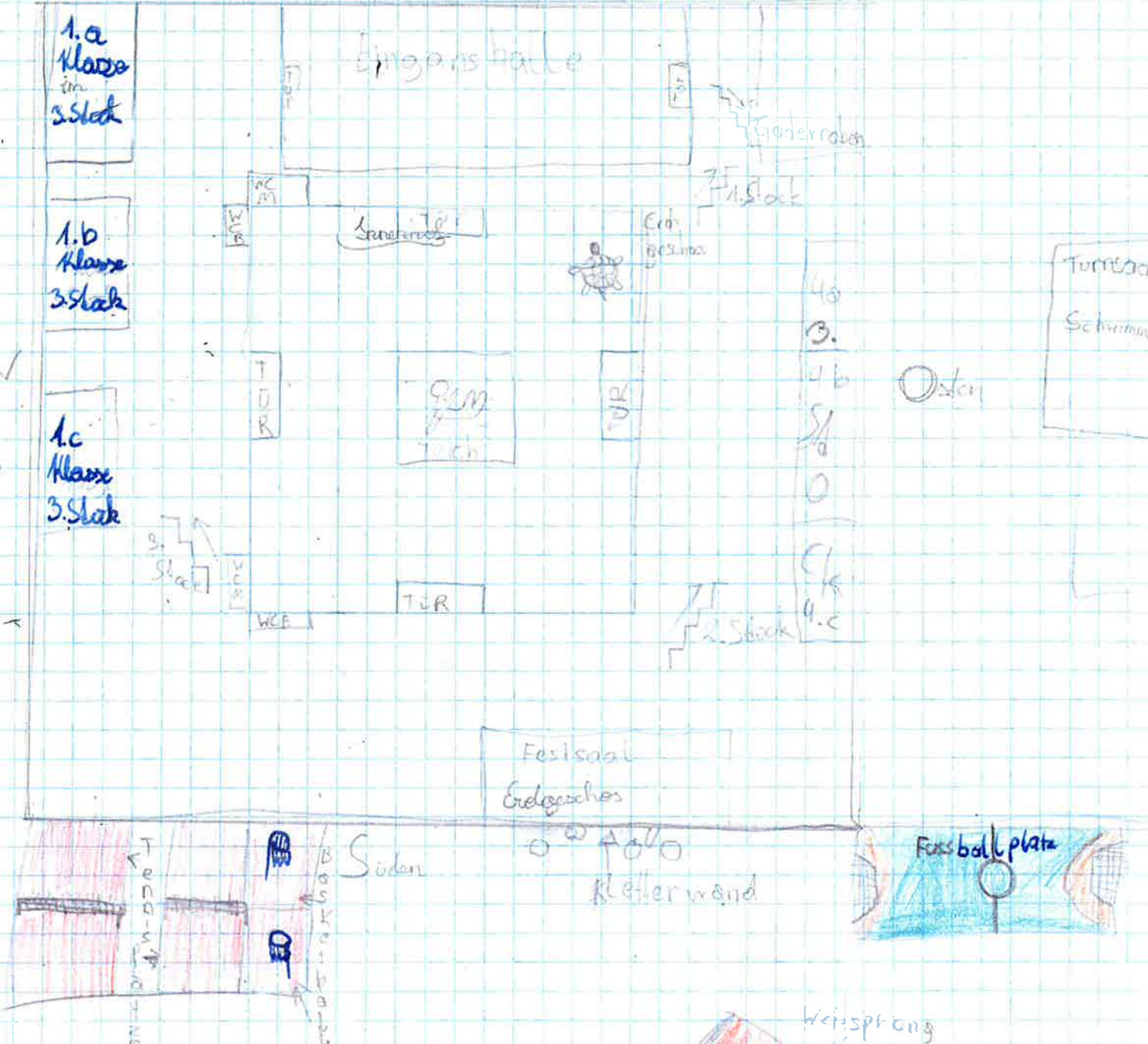



Handwritten text: "Sport Union" and "L.A. 2002/03"

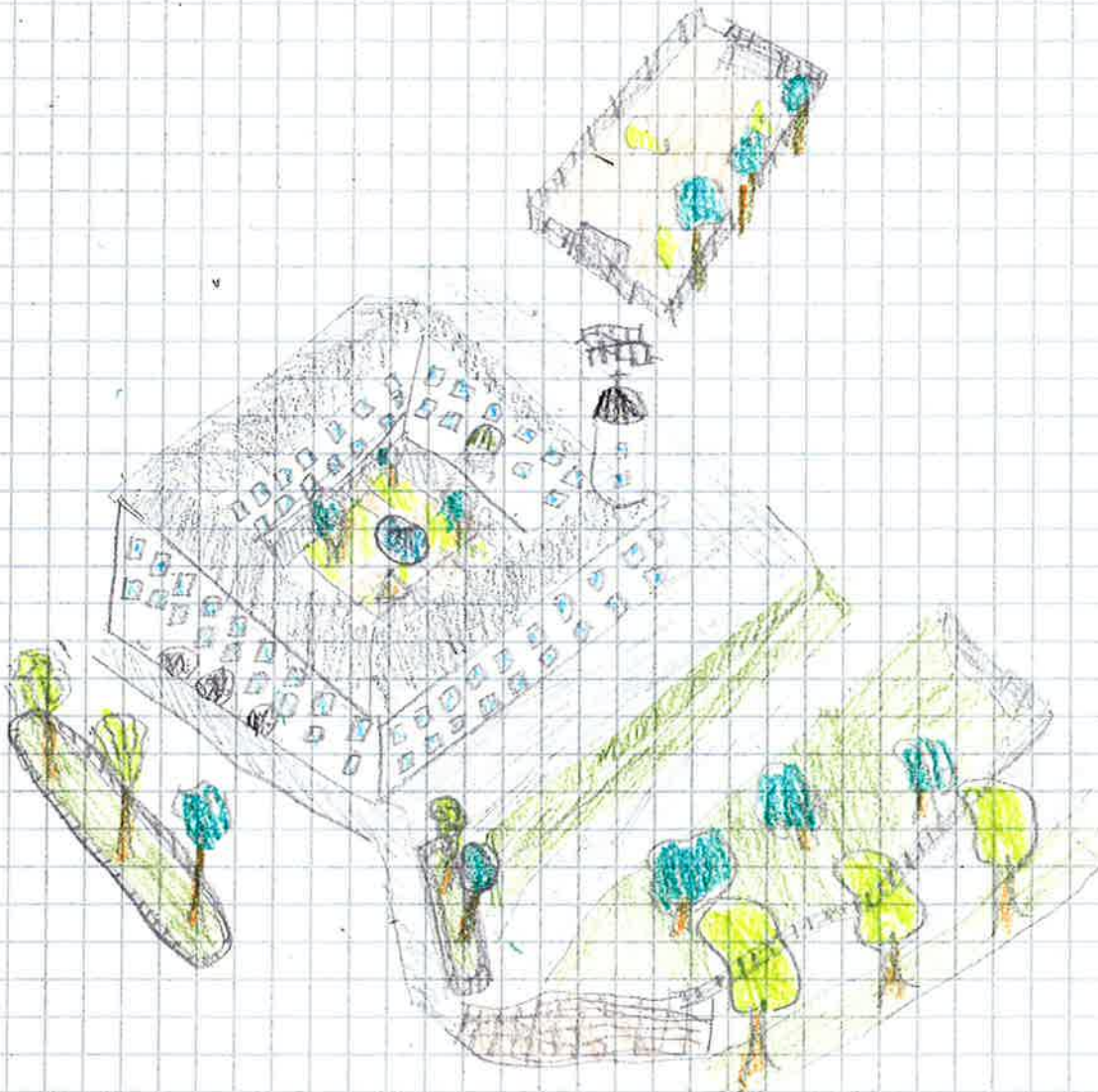



Meine Persönliche Karte vom 1. April

Julian Friedwagner  
1.4.2004, 2005

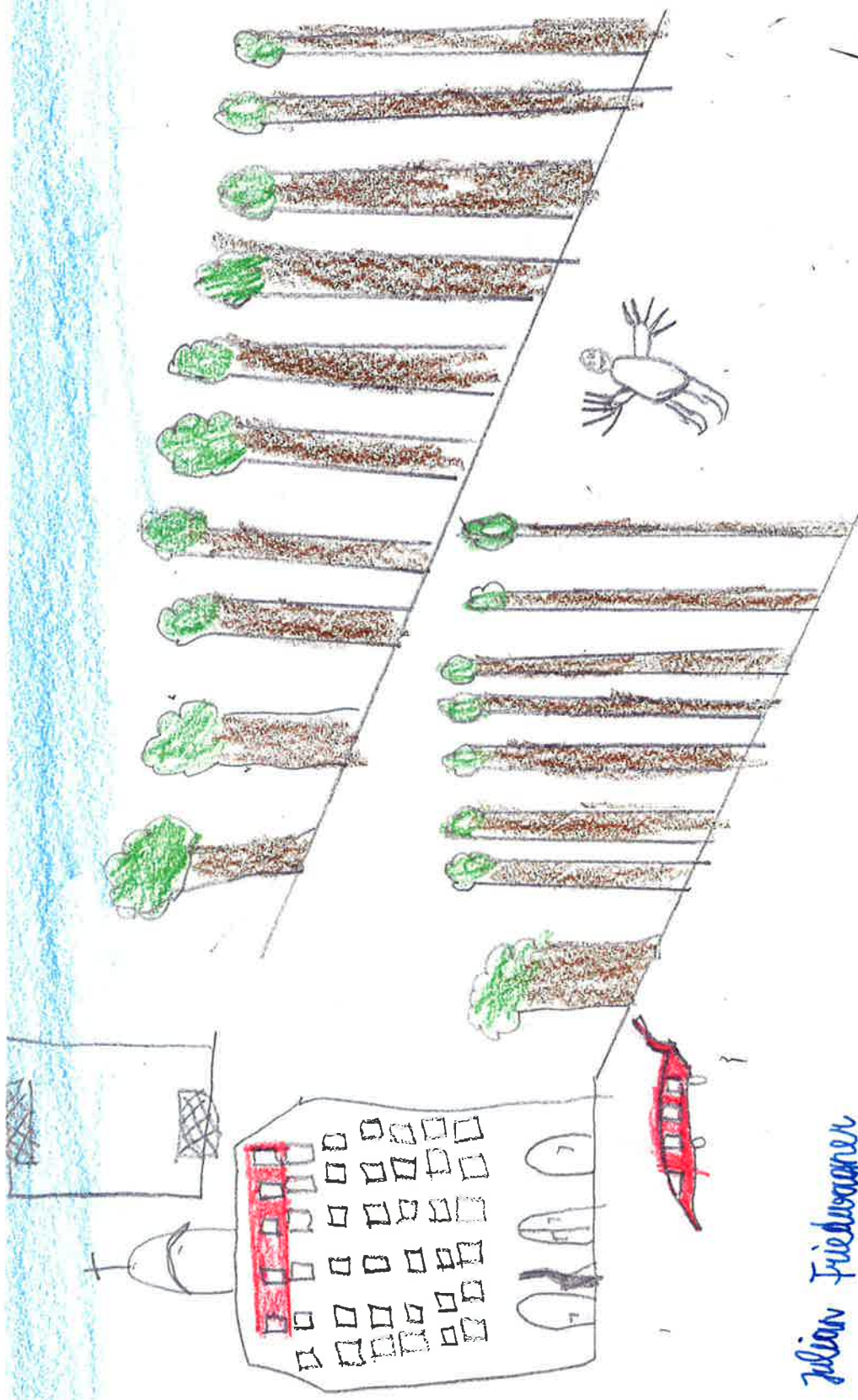



# Meine persönliche Karte vom Petinum

Franziska Gschwendner  
1. a 2004/05

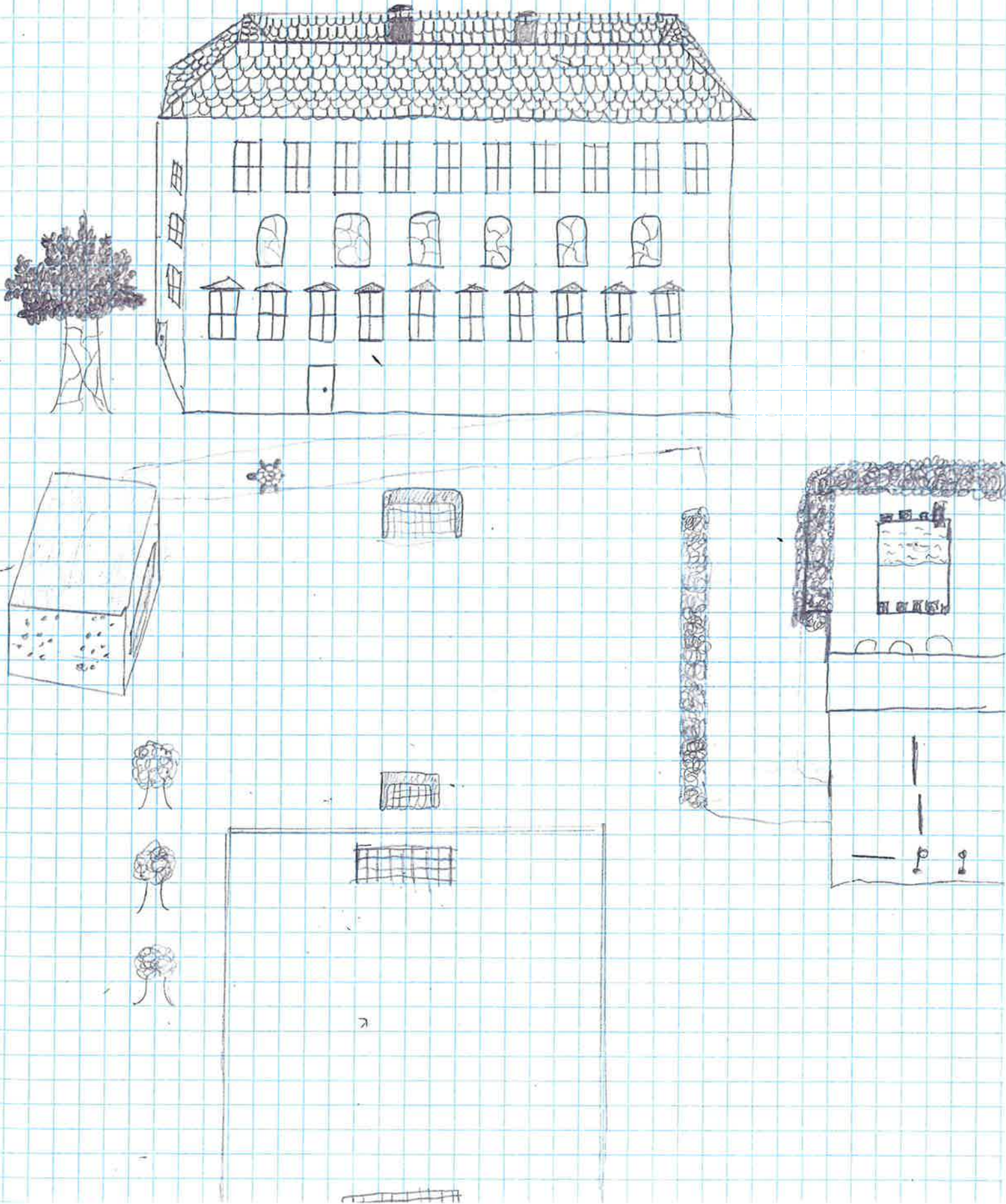



Moors petruskerke Moors van Petrinum

18/11/10  
Nieuwgrin

20/11/10



PETRINUM

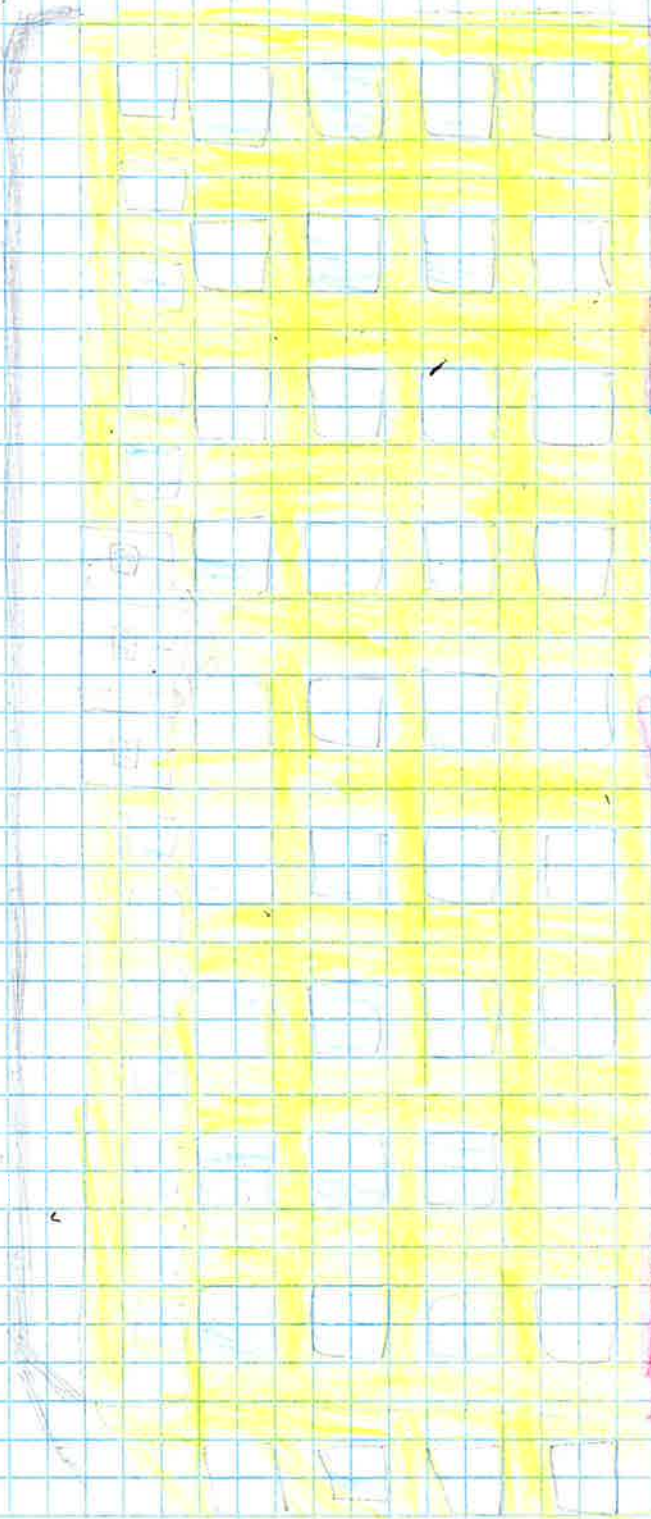



# kleine persönliche Karte vom Penitentiär!

Tanja Bredth  
1a 2004/05

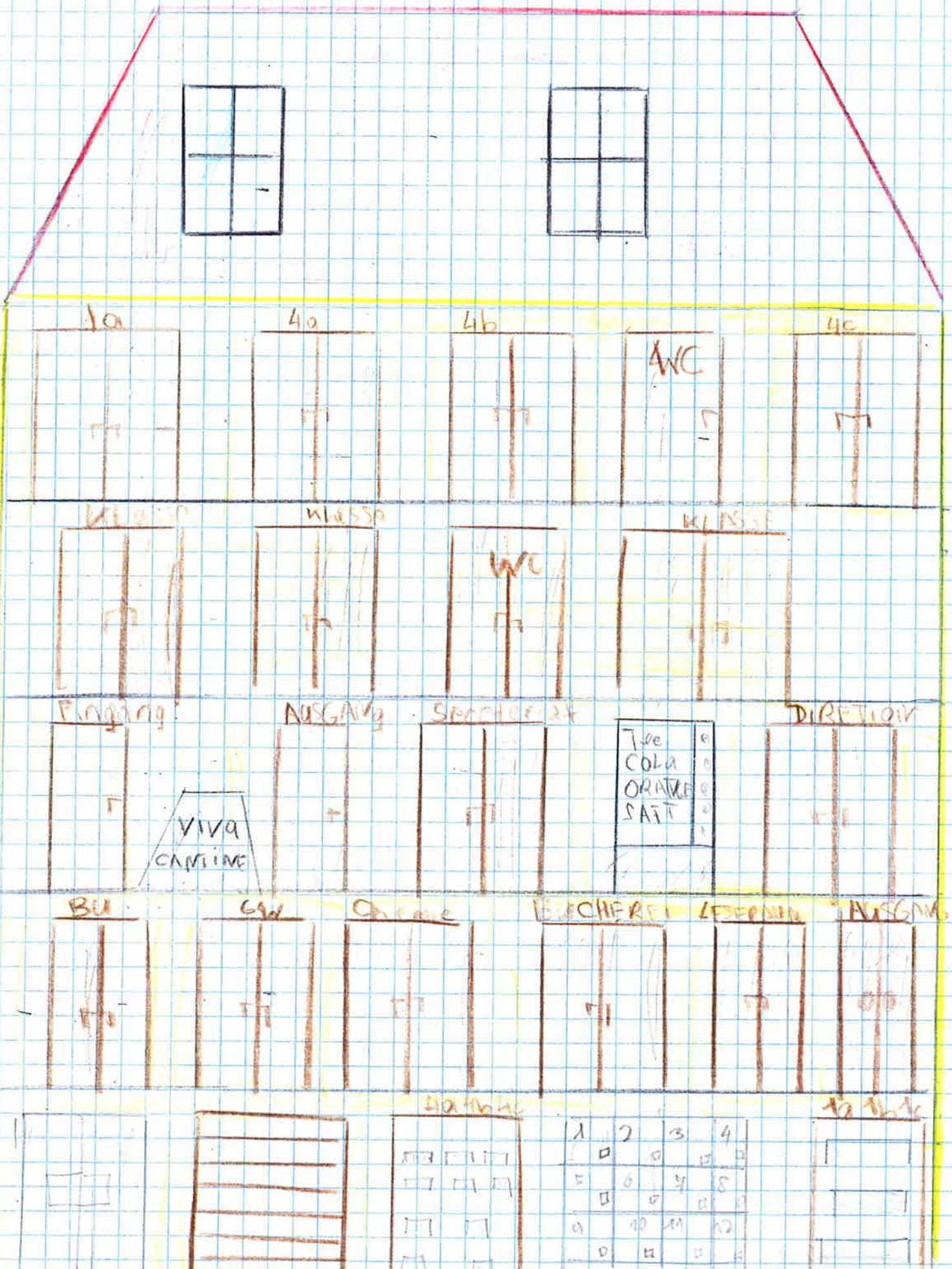



# Meine persönlich Karte vom Petrinum

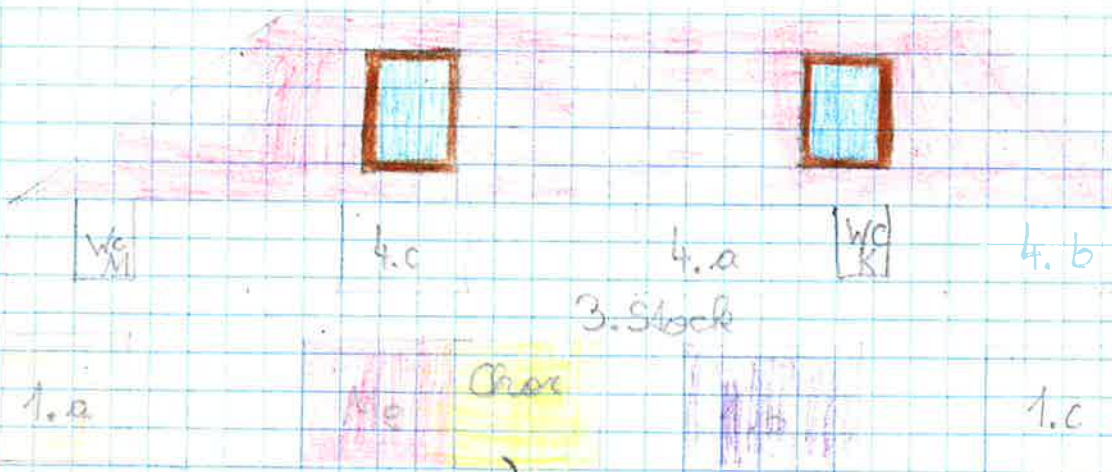

Viktoria Undesser

1.a 2004/05

## 1. Stock

Eingang  
Tür  
Kantine

Ausgang

Sekretariat  
Direktion

## Erdgeschoss

Bücher

Leseraum

Ausgang

GW

Chemie

BU

## Keller

Garten  
1.a, 1.c  
1.a, 1.c

Garten  
Zaun  
1.a, 1.c

30.05  
1.a, 1.c

1.a, 1.c  
1.a, 1.c

Spindel

Petrol



Meine persönliche Raum vom Verbunden

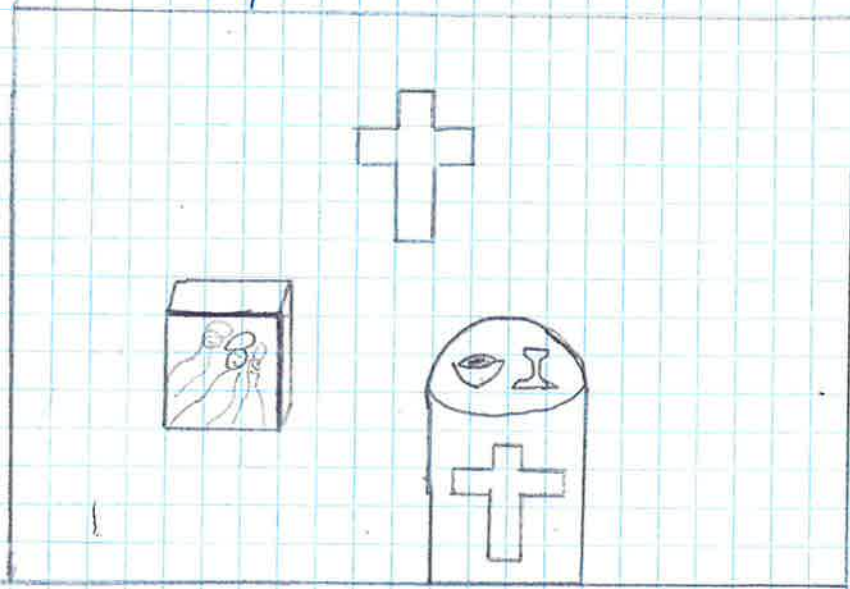

Markin Rainolt  
1.a  
2009/10

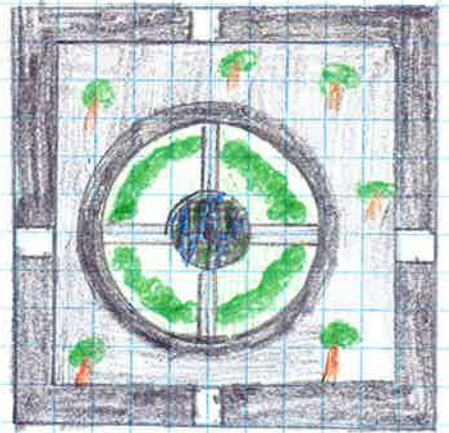



Meine persönliche Karte vom Erdinneren

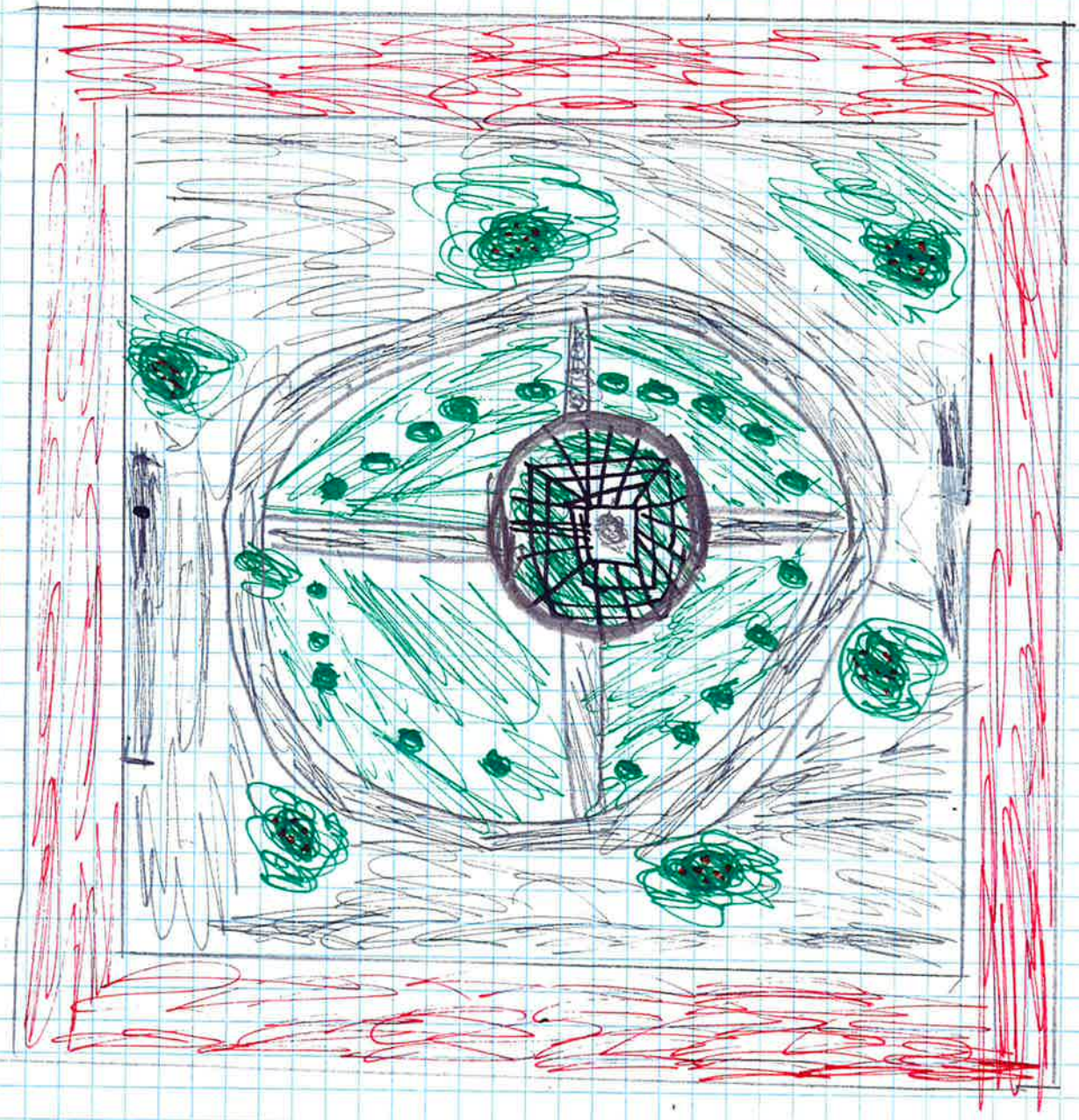

Maria Berthel 1a. 2004/05



Meine persönliche Karte  
vom Betraum

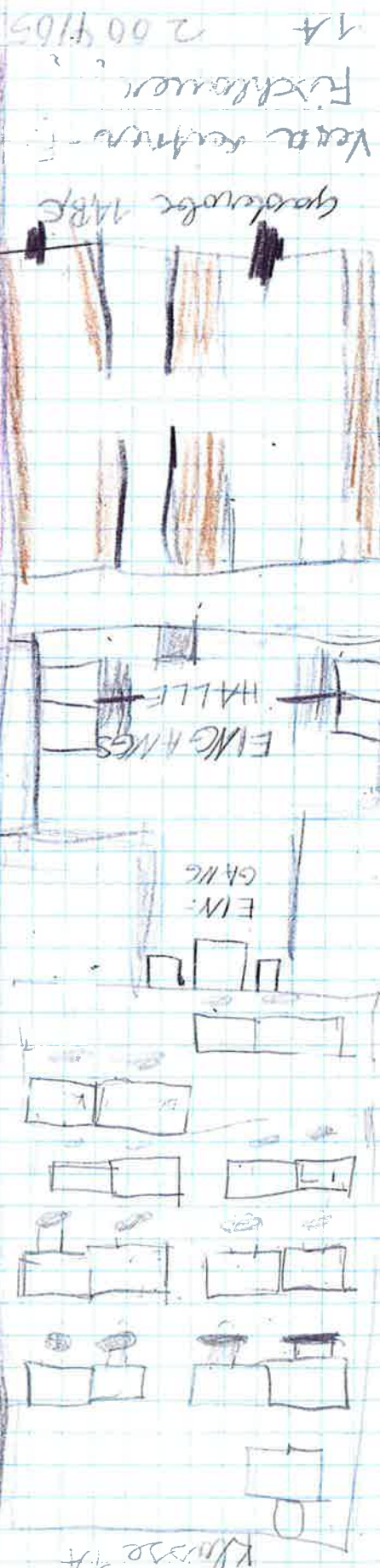



# Meine persönliche Karte vom Petrinium

Erdgeschoss

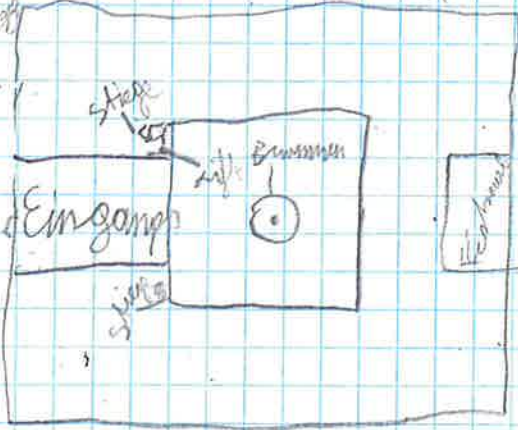

1. OG

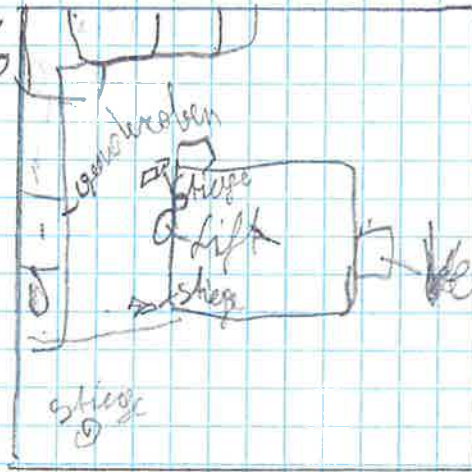

Verbindungsgang zum Schwimmbad

1 St.

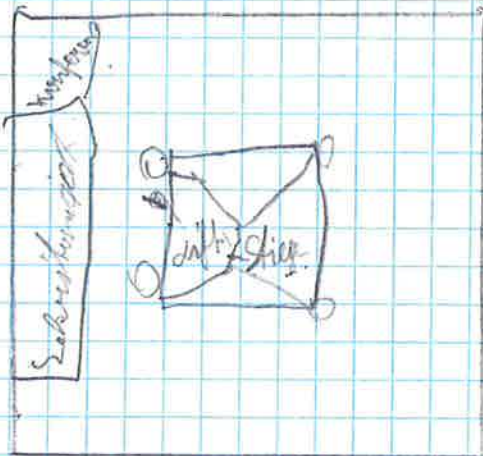

2 St.

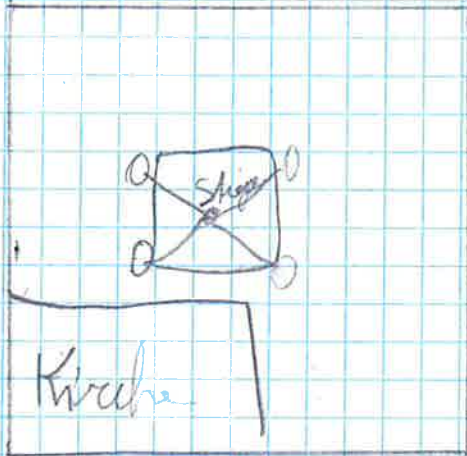

3 St.

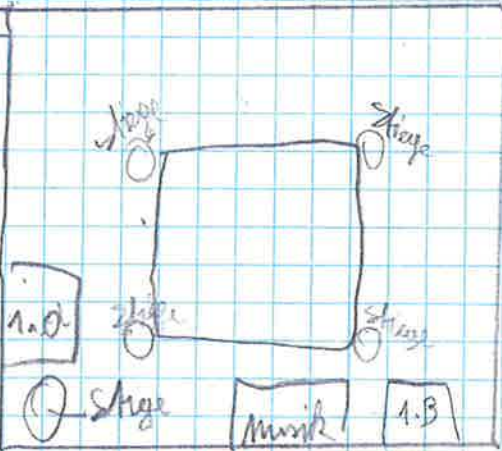

Barbara Hopfinger

1. a 2004/05

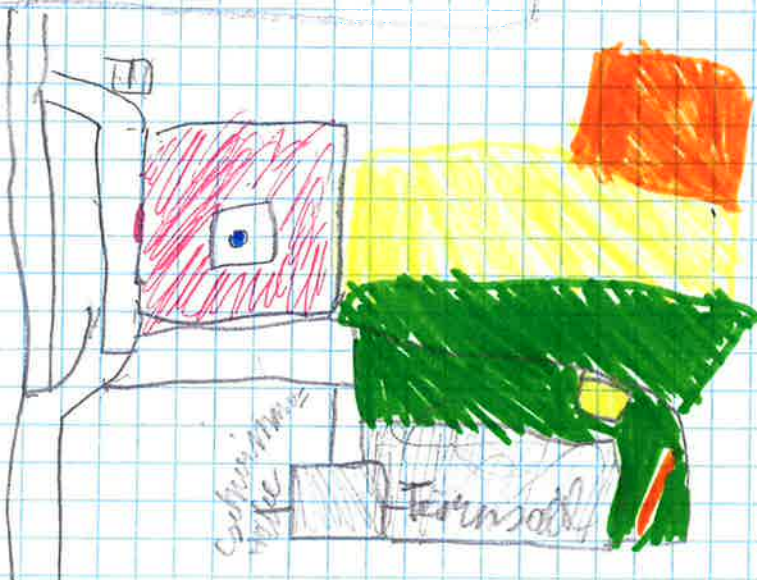



# Meine persönliche Karte vom Pezünem

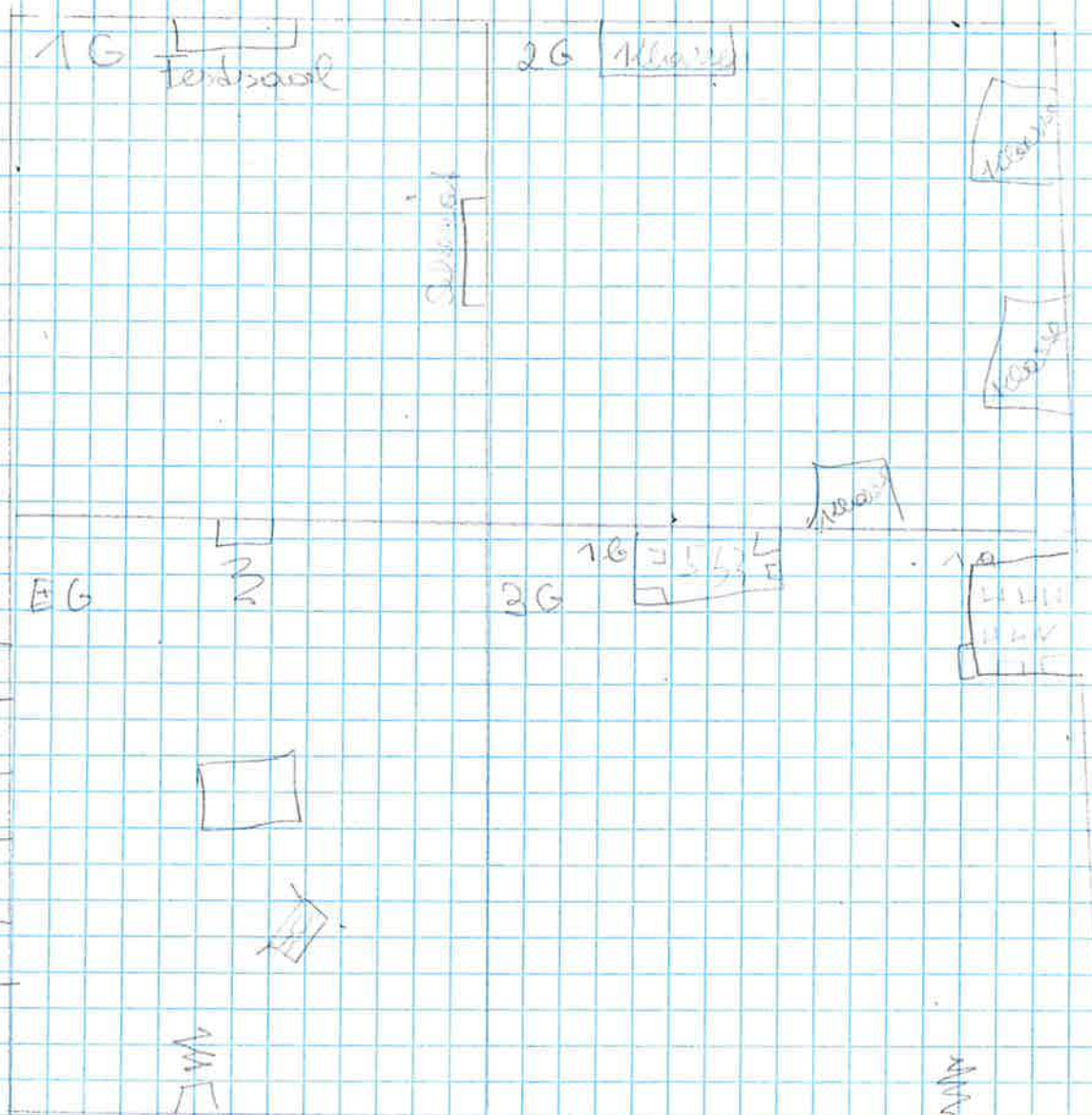
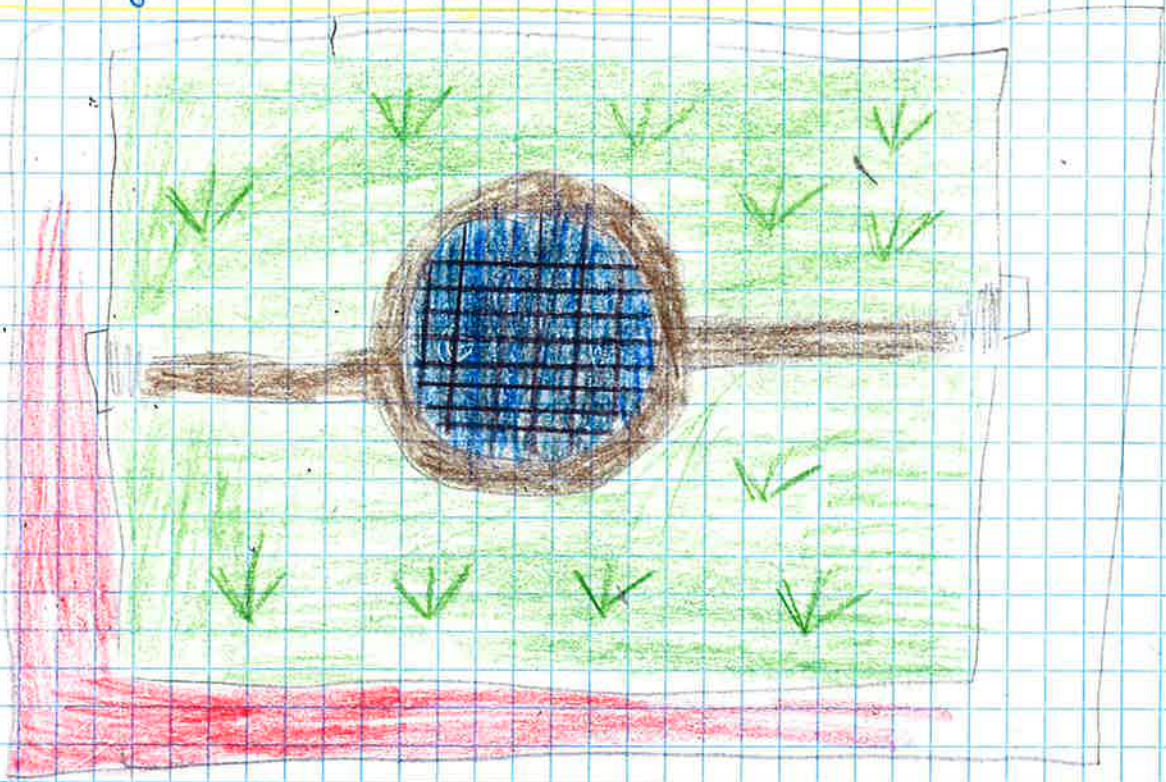

Angelika Haushälter

12. 2004 / 2005



Class  
Safarwan

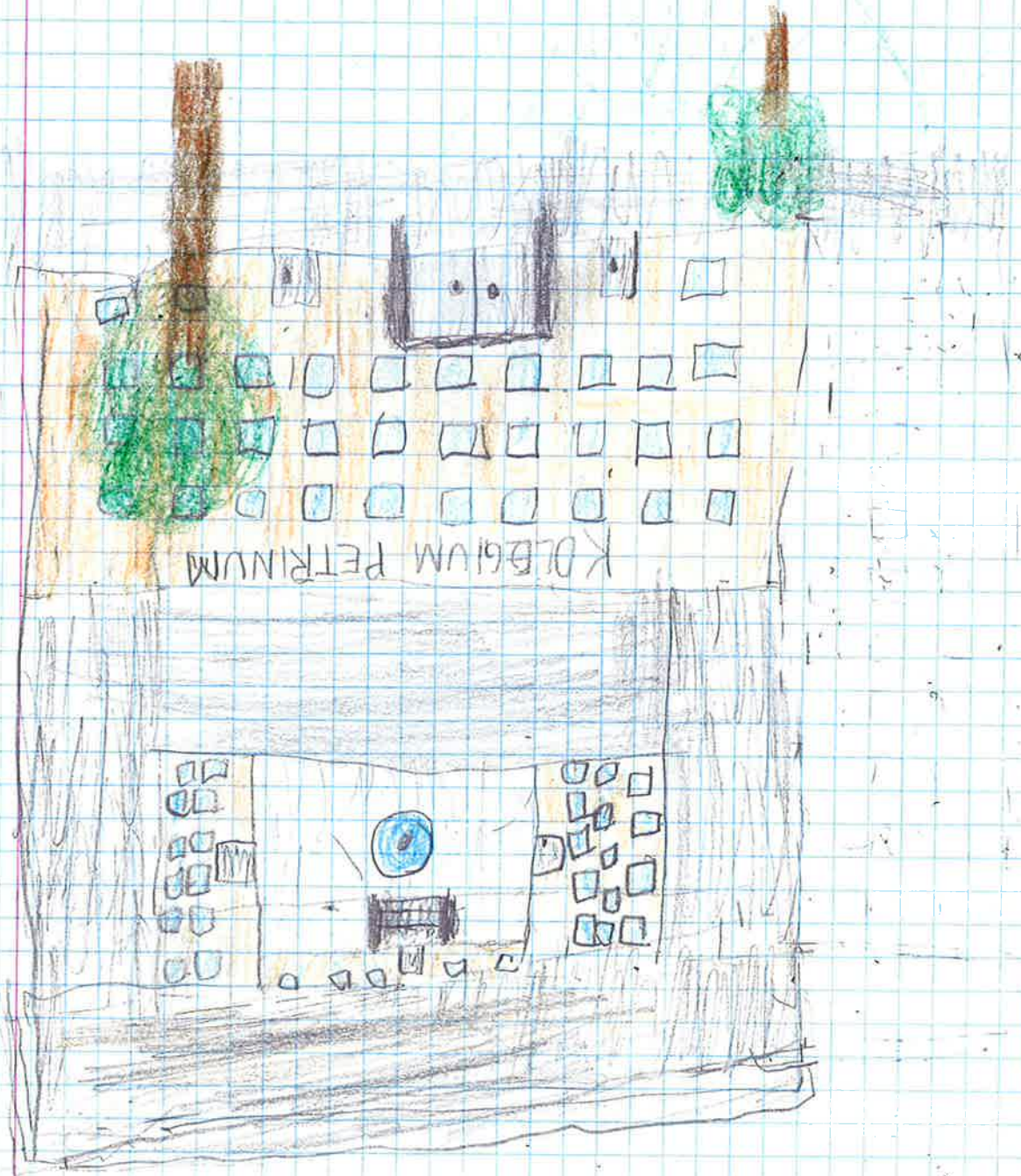

Meine persönliche Ansicht vom Safarwan



# Meine persönliche Karte vom Petrinum

Karin Katzenböck 1a 2004,05

UG: Gardarobe:

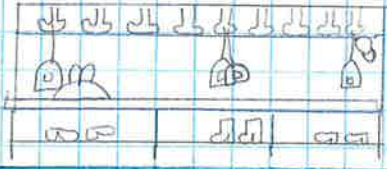

Werkraum:

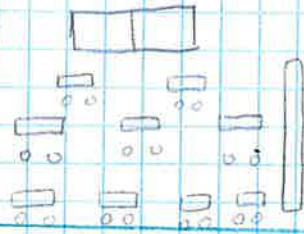

EG: Festsaal:

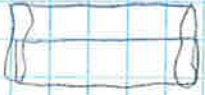

AAAAA

AAAAA

AAAAA

1.OB: Kantine:

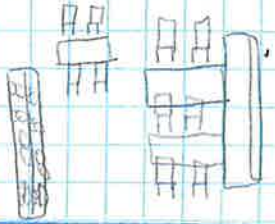

Biologieraum:

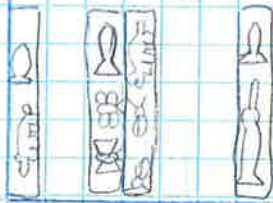

Chemieraum:

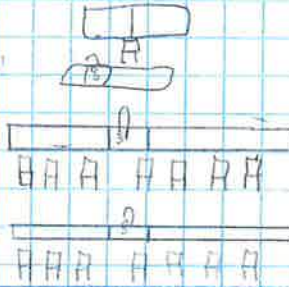

Sekretariat:

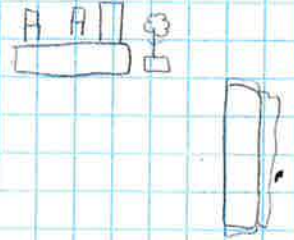

2.OB:

3.OB: Musiksaal: 1a, b, c



Twinhalle:

